

REVISIONS				
ZONE	REV.	DESCRIPTION	DATE	APPROVED
	A	REDRAWN IN CAD	3/25/2017	BGC

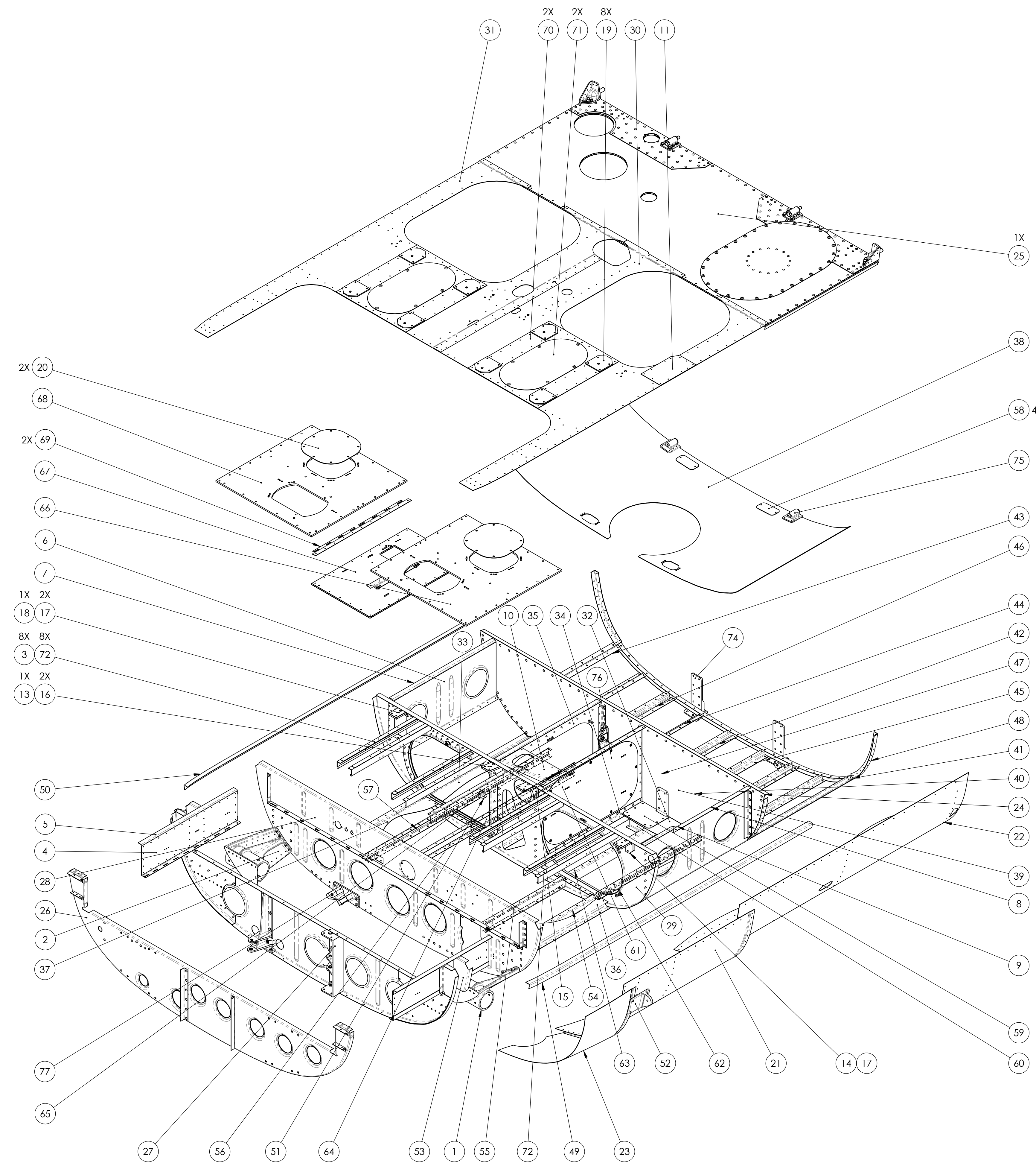

FIND NO.	QTY.	PART NUMBER	DESCRIPTION	DIAMETER	THICKNESS	MATERIAL	COMPL. SPEC.
38	1	S11-20-3525	PANEL, FUEL CELL SHIELD, FUSELAGE TUB	N/A	.062	ALUMINUM ALLOY	2024-T3
37	1	S11-20-3518-2	FLOOR PANEL, RIGHT HAND, STATION 42.0 - 58.0	N/A	.040	ALUMINUM ALLOY	2024-T3
36	1	S11-20-3518-1	FLOOR PANEL, LEFT HAND, STATION 42.0 - 58.0	N/A	.040	ALUMINUM ALLOY	2024-T3
35	1	S11-20-3517-2	BEAM ASSEMBLY, RIGHT HAND, FUSELAGE TUB, STATION 58.0 - 78.5	N/A	N/A	N/A	N/A
34	1	S11-20-3517-1	BEAM ASSEMBLY, LEFT HAND, FUSELAGE TUB, STATION 58.0 - 78.5	N/A	N/A	N/A	N/A
33	1	S11-20-3514-6	FLOOR PANEL, LEFT HAND, STATION 58.0 - 75.5	N/A	.040	ALUMINUM ALLOY	2024-T3
32	1	S11-20-3514-5	FLOOR PANEL, LEFT HAND, STATION 58.0 - 75.5	N/A	.040	ALUMINUM ALLOY	2024-T3
31	1	S11-20-3512-2	FLOOR PANEL, RIGHT HAND, FUSELAGE TUB, STATION 21.63 - 79.25	N/A	.051	ALUMINUM ALLOY	2024-T3
30	1	S11-20-3512-1	FLOOR PANEL, LEFT HAND, FUSELAGE TUB, STATION 21.63 - 79.25	N/A	.051	ALUMINUM ALLOY	2024-T3
29	1	S11-20-3511	FRAME ASSEMBLY, FUSELAGE TUB, STATION 58.0	N/A	N/A	N/A	N/A
28	1	S11-20-3510	FRAME ASSEMBLY, FUSELAGE TUB, STATION 42.0	SUB-ASSEMBLY	SUB-ASSEMBLY	SUB-ASSEMBLY	SUB-ASSEMBLY
27	1	S11-20-3509	FRAME ASSEMBLY, FUSELAGE TUB, STATION 33.0	N/A	N/A	N/A	N/A
26	1	S11-20-3508	FRAME ASSEMBLY, FUSELAGE TUB, STATION 23.0	N/A	N/A	N/A	N/A
25	1	S11-20-3505	FLOOR ASSEMBLY, FUSELAGE, STATION 78.56 - 101.0	N/A	N/A	N/A	N/A
24	1	S11-20-3504	BULKHEAD ASSEMBLY, FUSELAGE TUB, STATION 78.5	N/A	N/A	N/A	N/A
23	1	S11-20-3500-3	SKIN, OUTER, STATION 23.00 - 58.00	N/A	.040	ALUMINUM ALLOY	2024-T3
22	1	S11-20-3500-2	SKIN, OUTER, STATION 57.25 - 97.38	N/A	.040	ALUMINUM ALLOY	2024-T3
21	1	S11-20-3500-1	SKIN, OUTER, STATION 23.00 - 58.00	N/A	.040	ALUMINUM ALLOY	2024-T3
20	2	S11-20-3388	COVER, FUSELAGE FLOOR, NOSE SECTION	N/A	.064	ALUMINUM ALLOY	2024-T3
19	8	S11-20-3360-2	PLATE, FUSELAGE CENTER SECTION, STATION 55.53	N/A	.125	ALUMINUM ALLOY	2024-T3
18	1	S11-20-3329-6	ANGLE, TUB SAFETY BELT	N/A	N/A	ALUMINUM ALLOY	2024-T3
17	2	S11-20-3329-5	SHIM PLATE, ANGLE, TUB SAFETY BELT	N/A	.040	ALUMINUM ALLOY	2024-T3
16	2	S11-20-3329-4	SHIM PLATE, ANGLE, TUB SAFETY BELT	N/A	.040	ALUMINUM ALLOY	2024-T3
15	1	S11-20-3329-3	ANGLE, TUB SAFETY BELT	N/A	N/A	ALUMINUM ALLOY	2024-T3
14	1	S11-20-3329-2	ANGLE, TUB SAFETY BELT	N/A	N/A	ALUMINUM ALLOY	2024-T3
13	1	S11-20-3329-1	ANGLE, TUB SAFETY BELT	N/A	N/A	ALUMINUM ALLOY	2024-T3
12	1	S11-20-3303-2	ANGLE, FUSELAGE BEAM ATTACH, STATION 58.0 - 78.5	N/A	.040	ALUMINUM ALLOY	2024-T3
11	1	S11-20-3286	DOUBLER, FUSELAGE, LOWER CABIN, COLLECTIVE	N/A	.040	ALUMINUM ALLOY	6061-16
10	1	S11-20-3280	CHANNEL, FUSELAGE MAIN FITCH STICK BRACKET	N/A	.040	ALUMINUM ALLOY SHEET	2024-T3
9	1	S11-20-3269-4	ANGLE, FUSELAGE TUB, STATION 58.0 - 78.5	N/A	.040	ALUMINUM ALLOY	2024-T3
8	1	S11-20-3269-3	ANGLE, FUSELAGE TUB, STATION 58.0 - 78.5	N/A	.040	ALUMINUM ALLOY	2024-T3
7	1	S11-20-3269-2	ANGLE, FUSELAGE TUB, STATION 58.0 - 78.5	N/A	.040	ALUMINUM ALLOY	2024-T3
6	2	S11-20-3269-1	PANEL, FUSELAGE TUB, STATION 58.0 - 78.5	N/A	.040	ALUMINUM ALLOY	2024-T3
5	4	S11-20-3265-2	ANGLE, WEB SHEET SUPPORT, STATION 23.0 - 42.0	N/A	.040	ALUMINUM ALLOY	2024-T3
4	2	S11-20-3265-1	SHEET, WEB, STATION 23.0 - 42.0	N/A	.040	ALUMINUM ALLOY	2024-T3
3	8	S11-20-3263	ANGLE, FUSELAGE CENTER SECTION	N/A	N/A	ALUMINUM ALLOY	2024-T3
2	1	S11-20-3219-2	FITTING, NOSE WHEEL, FUSELAGE TUB STATION 33.0 & 42.0	N/A	N/A	ALUMINUM ALLOY	2024-T3
1	1	S11-20-3219-1	FITTING, NOSE WHEEL, FUSELAGE TUB STATION 33.0 & 42.0	N/A	N/A	ALUMINUM ALLOY	2024-T3

FIND NO.	QTY.	PART NUMBER	DESCRIPTION	DIAMETER	THICKNESS	MATERIAL	COMPL. SPEC.
77	1	S11-40-4560	BRACKET ASSEMBLY, PULLEY MOUNTING, YAW CONTROL	N/A	N/A	N/A	N/A
76	1	S11-40-2130	BRACKET ASSEMBLY, MOUNTING, FLIGHT CONTROLS, AZIMUTH CONTROLS	N/A	N/A	N/A	N/A
75	2	S11-30-1205	FITTING, POWERPLATE, ENGINE SUPPORT	N/A	N/A	ALUMINUM ALLOY	2024-T3
74	2	S11-25-2202-2	FITTING ASSEMBLY, MAIN LANDING GEAR, LEFT	N/A	N/A	N/A	N/A
73	2	S11-25-2202-1	FITTING ASSEMBLY, MAIN LANDING GEAR, RIGHT	N/A	N/A	N/A	N/A
72	8	S11-20-3626	SPACER, FUSELAGE TUB ASSEMBLY, STATION 42.0 - 58.0	N/A	.040	ALUMINUM ALLOY	2024-T3
71	2	S11-20-3608	COVER ASSEMBLY, FUSELAGE CENTER SECTION	N/A	N/A	N/A	N/A
70	2	S11-20-3607	DOUBLER, FUSELAGE, CENTER SECTION	N/A	.040	ALUMINUM ALLOY	2024-T3
69	2	S11-20-3602	STIFFENER ASSEMBLY, FUSELAGE, STATION 23.0 - 42.0	N/A	N/A	N/A	N/A
68	1	S11-20-3600-3	FLOOR PANEL ASSEMBLY, FUSELAGE, RIGHT, STATION 23.0 - 42.0	N/A	.732	PLYMETAL	N/A
67	1	S11-20-3600-2	FLOOR PANEL ASSEMBLY, FUSELAGE, CENTER, STATION 23.0 - 42.0	N/A	.732	PLYMETAL	N/A
66	1	S11-20-3600-1	FLOOR PANEL ASSEMBLY, FUSELAGE, LEFT, STATION 23.0 - 42.0	N/A	.732	LAMINATED YELLOW POPPLAR	N/A
65	1	S11-20-3595	CHANNEL, BLR 15.78, STATION 58.0 - 78.5	N/A	.040	ALUMINUM ALLOY	2024-T3
64	1	S11-20-3594	CHANNEL, BLR 9.38, STATION 58.0 - 78.5	N/A	.040	ALUMINUM ALLOY	2024-T3
63	1	S11-20-3593	CHANNEL, BLR 9.53, STATION 58.0 - 78.5	N/A	.040	ALUMINUM ALLOY SHEET	2024-T3
62	1	S11-20-3592	CHANNEL, BLR 15.78, STATION 58.0 - 78.5	N/A	.04	ALUMINUM ALLOY	2024-T3
61	1	S11-20-3591-2	SUPPORT, FUSELAGE TUB, RIGHT HAND, STATION 74.0	N/A	.040	ALUMINUM ALLOY	2024-T3
60	1	S11-20-3591-1	SUPPORT, FUSELAGE TUB, LEFT HAND, STATION 74.0	N/A	.040	ALUMINUM ALLOY	2024-T3
59	2	S11-20-3588	COVER, FLOOR ACCESS HOLE, FUSELAGE TUB	N/A	.040	ALUMINUM ALLOY	2024-T3
58	4	S11-20-3587	PLATE, FUSELAGE CENTER SECTION, LOWER PANEL	N/A	.053	ALUMINUM ALLOY	2024-T3
57	1	S11-20-3571	CHANNEL, FUSELAGE TUB	N/A	.040	ALUMINUM ALLOY	2024-T3
56	1	S11-20-3570	CHANNEL, FUSELAGE TUB, STATIONS 42.0 - 58.0	N/A	.04	ALUMINUM ALLOY	2024-T3
55	1	S11-20-3569	CHANNEL, FUSELAGE TUB	N/A	.040	ALUMINUM ALLOY	2024-T3
54	1	S11-20-3568	CHANNEL, FUSELAGE TUB	N/A	.040	ALUMINUM ALLOY	2024-T3
53	2	S11-20-3567-2	FORMER, FUSELAGE, RIGHT HAND, STATION 34.93	N/A	.040	ALUMINUM ALLOY	2024-T3
52	2	S11-20-3566-2	FITTING, FUSELAGE, STATION 34.63, RIGHT HAND	N/A	N/A	ALUMINUM ALLOY	2024-T3
51	1	S11-20-3563	CHANNEL ASSEMBLY, FUSELAGE FRICTION BAR SUPPORT	N/A	N/A	N/A	N/A
50	1	S11-20-3562-2	ANGLE, FUSELAGE, NOSE SECTION, STATION 23.0 - 78.5	N/A	.04	ALUMINUM ALLOY	2024-10
49	1	S11-20-3562-1	ANGLE, FUSELAGE, NOSE SECTION, STATION 23.0 - 78.5	N/A	.04	ALUMINUM ALLOY	2024-10
48	2	S11-20-3550-2	ANGLE, FUSELAGE TUB, STATIONS 78.5 & 101.0	N/A	.051	ALUMINUM ALLOY SHEET	2024-T3
47	1	S11-20-3533	RING, FUSELAGE, STATION 84.93	N/A	.040	ALUMINUM ALLOY	2024-O
46	2	S11-20-3531	STIFFENER, FUSELAGE CENTER SECTION, STATION 78.5 - 101.0	N/A	.040	ALUMINUM ALLOY SHEET	2024-T3
45	1	S11-20-3530-3	STIFFENER, FUSELAGE CENTER SECTION, STATION 78.5 - 101.0	N/A	.040	ALUMINUM ALLOY	2024-T3
44	1	S11-20-3530-2	STIFFENER, FUSELAGE CENTER SECTION, STATION 78.5 - 101.0	N/A	.040	ALUMINUM ALLOY	2024-T3
43	4	S11-20-3530-1	STIFFENER, FUSELAGE CENTER SECTION, STATION 78.5 - 101.0	N/A	.040	ALUMINUM ALLOY SHEET	2024-T3
42	1	S11-20-3529	STIFFENER, FUSELAGE CENTER SECTION, STATION 78.5 - 101.0	N/A	.040	ALUMINUM ALLOY SHEET	2024-T3
41	1	S11-20-3528	CHANNEL, FUSELAGE CENTER SECTION, LOWER PANEL	N/A	.040	ALUMINUM ALLOY SHEET	2024-T3
40	1	S11-20-3527	RING, FUSELAGE, CENTER SECTION LOWER PANEL	N/A	.040	ALUMINUM ALLOY	2024-T3
39	1	S11-20-3526	WELL, FUSELAGE, CENTER SECTION LOWER PANEL	N/A	.053	LECORNE PLASTIC	N/A

NOTE:
1. APPLIES TO BOTH THE ICS40 AND LS7 HELICOPTER.

PROPRIETARY AND CONFIDENTIAL			Vertical Aviation Technologies, Incorporated			
THIS DOCUMENT CONTAINS PROPRIETARY INFORMATION THAT IS THE SOLE PROPERTY OF VERTICAL AVIATION TECHNOLOGIES, INCORPORATED AND IS TENDERED SUBJECT TO THE FOLLOWING CONDITIONS. THE INFORMATION (A) WILL BE RETAINED IN CONFIDENCE; (B) WILL NOT BE COPIED OR REPRODUCED IN WHOLE OR IN PART AND (C) WILL NOT BE USED OR INCORPORATED IN ANY PRODUCT EXCEPT UNDER AN EXPRESS WRITTEN AGREEMENT WITH VERTICAL AVIATION TECHNOLOGIES, INCORPORATED.			UNLESS OTHERWISE SPECIFIED: DIMENSIONS ARE IN INCHES	DRAWN: J. CLARKE	DATE: 3/20/2017	1609 Mangrove Road, Sanford, Florida 32773 407-322-9488 www.vertical-aviation.com
CHECKED: BGC	APPROVED: BGC	DATE: 3/25/2017	TITLE: LOWER CABIN ASSEMBLY	REV: A	SIZE: DWG NO. E	SCALE: 1:8
SHEET: 11-01-1500-K	300L/300S	USED ON: NEXT ASSY	APPLICATION:	WEIGHT: 02	SHEET 1 OF 1	